

B4 DETAIL
1" = 1'-0"

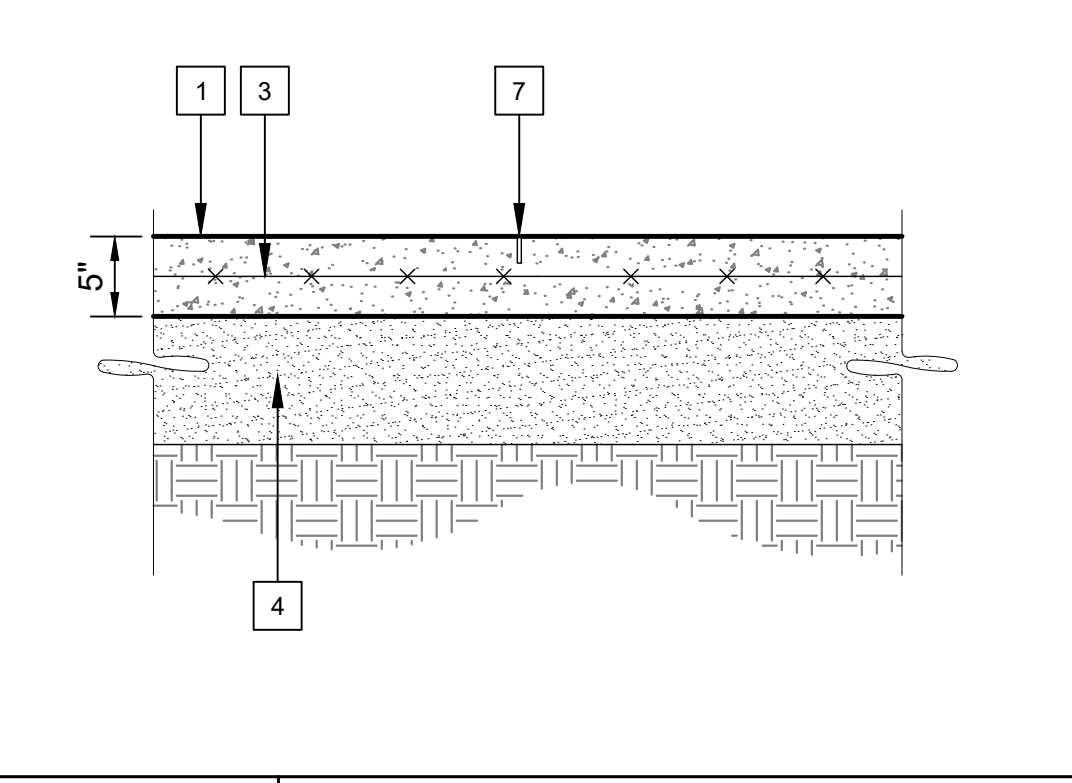

C4 DETAIL
1" = 1'-0"

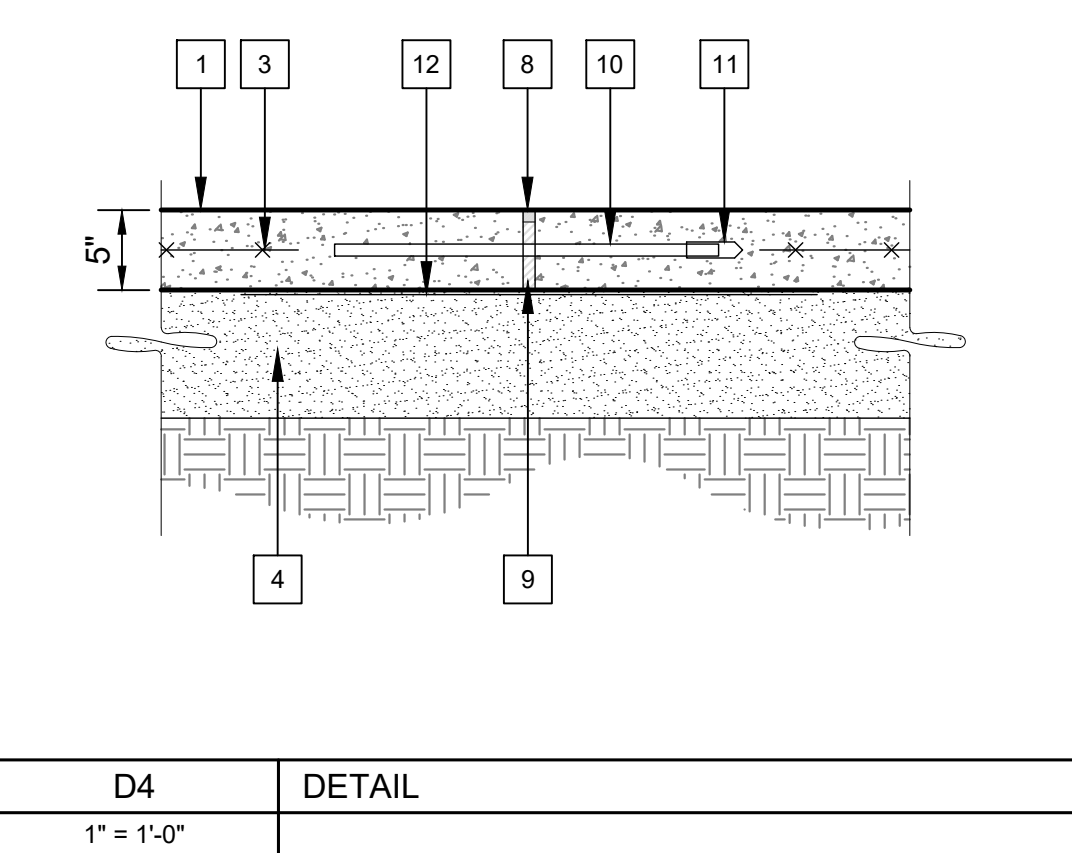

D4 DETAIL
1" = 1'-0"



F4 DETAIL
1" = 1'-0"

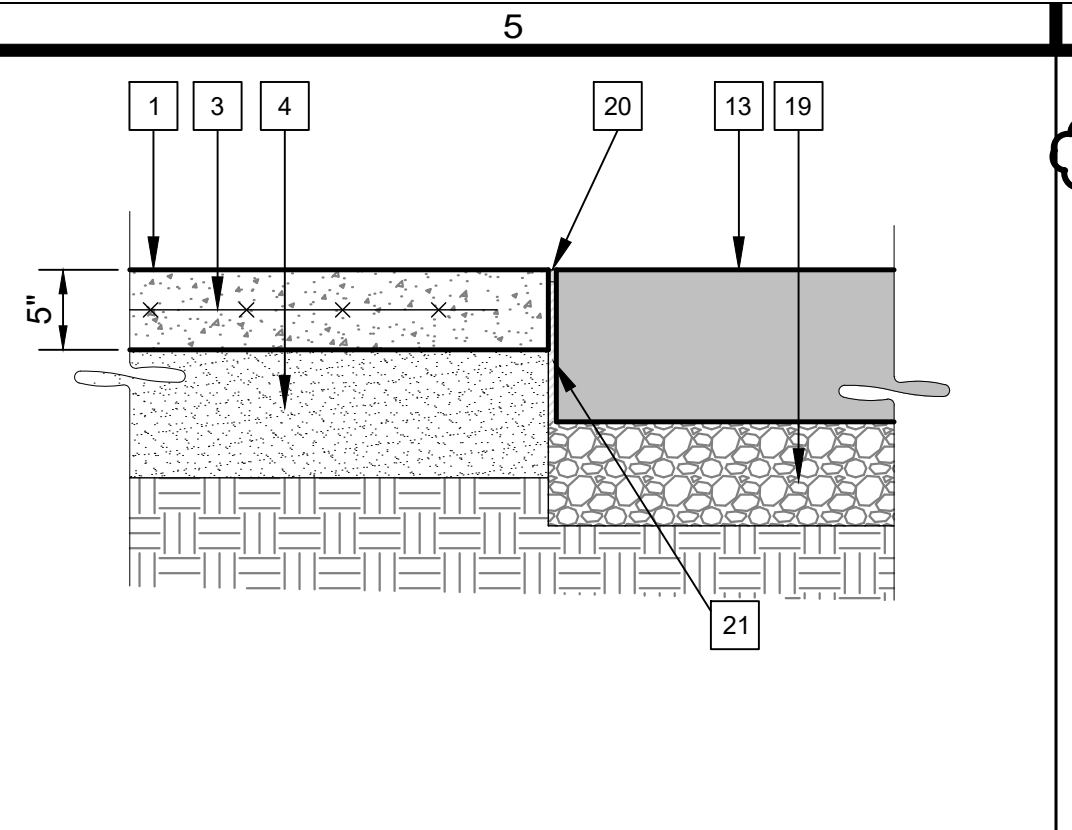

B5 DETAIL
1" = 1'-0"

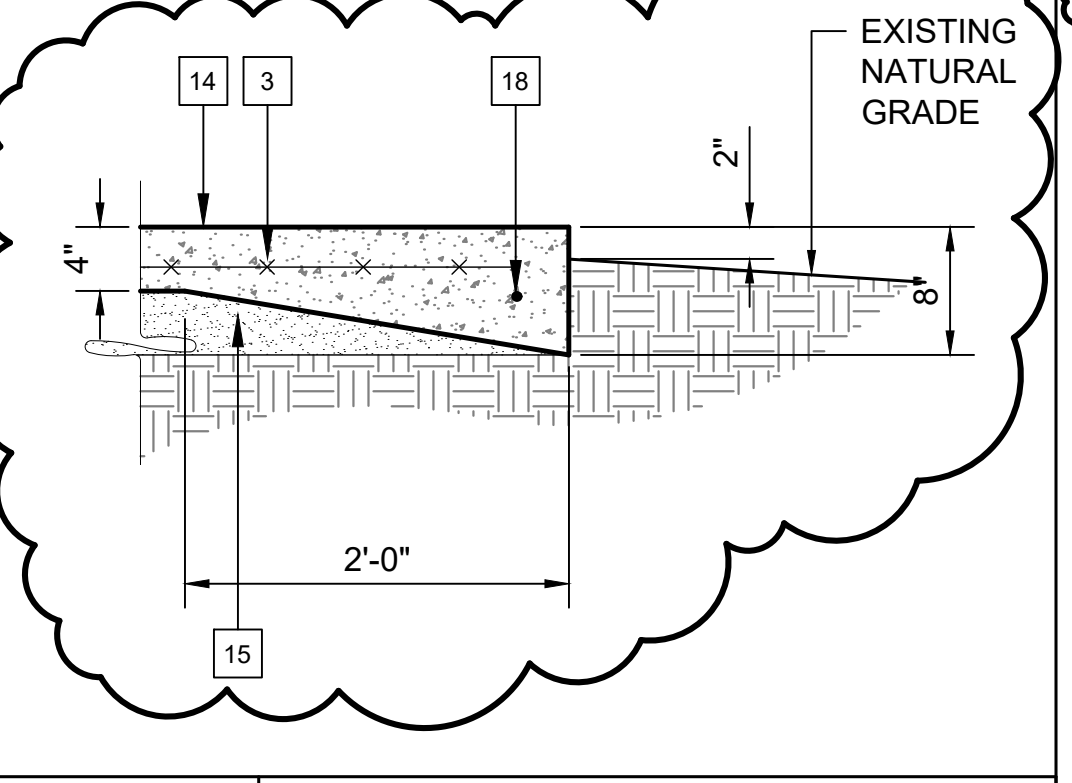

C5 DETAIL
1" = 1'-0"



D5 DETAIL
1" = 1'-0"



F5 DETAIL
1" = 1'-0"

- KEYED NOTES:**
- 5" BROOM FINISH PORTLAND CEMENT CONCRETE PAVING, 4,500 PSI AT 28 DAYS.
 - 1/4" PRE-MOLDED JOINT FILLER (1/3 DEPTH).
 - 6 x 6 x NO. 6 WWF.
 - 8" SELECT FILL SUB-GRADE COMPACTED TO MINIMUM 95%.
 - #4 x 30" LONG AT 30" ON CENTER.
 - KEYWAY.
 - SAW CUT JOINT (1/3 DEPTH).
 - REMOVE 3/4" FILLER STRIP AND FILL WITH SEALANT.
 - EXPANSION JOINT MATERIAL.
 - 3/4" SMOOTH DOWELS x 18" LONG AT 18" ON CENTER. LUBRICATE CAP SIDE.
 - EXPANSION CAPS, ALTERNATE ENDS.
 - 36" WIDE FILTER CLOTH CENTERED ON JOINT.
 - PRE-CAST CONCRETE BASE, BY TESLA. PRE-CAST BASE SHALL MAINTAIN A CROSS SLOPE OF 1-2% AND A LONGITUDINAL SLOPE OF 0-5%.
 - 4" PORTLAND CEMENT, 3,000 PSI CONCRETE SIDEWALK WITH BROOM FINISH.
 - 4" SUB-GRADE COMPACTED TO MINIMUM 95%.
 - CAST-IN-PLACE ADA COMPLIANT DETECTABLE WARNING STRIP 24" WIDE x WIDTH OF SIDEWALK. REFER TO E4 AND F4 SHEET A0.04.
 - NOTE NOT USED.
 - CONTINUOUS #4.
 - 6-1/2" MINIMUM 95% RELATIVE COMPACTED CLASS 2 AGGREGATE BASE.
 - BITUMINOUS SEALANT.
 - 1/2" EXPANSION JOINT MATERIAL.
 - SAW CUT JOINT (1/4 DEPTH F SLAB).
 - EXISTING CONCRETE PAVING.
 - SLOPE DOWN (1:12 MAX.) FROM EXISTING SIDEWALK TO DRIVEWAY ELEVATION.
 - DASHED LINES INDICATE SUPERCHARGER TO BE INSTALLED IN PHASE 2.

PROJECT NO: 26011

DRAWN: DJH

CHECKED: WAT

DATE: APRIL 2026

LAST REV: 5-12-26

A0.03

© 2026, Alliance Design Group, LLC all rights reserved.

Site Development for

Broadway EV Charging LLC

2501 Broadway Avenue - Alexandria, Louisiana 71302

1439 Centre Ct., Ste 401

Alexandria, LA 71301

Ph: 318.445.3151

Fx: 318.445.3988

Em: adg@adgllc.net

ALLIANCE
DESIGN GROUP, LLC